

# TEOS+ 100RT

## 1-3kVA

EPO Feature

DSP Control

LCD Display

|              |            |              |             |              |
|--------------|------------|--------------|-------------|--------------|
|              |            |              |             |              |
| TOWER / RACK | UPS ONLINE | POWER FACTOR | PLUG & PLAY | ECO FRIENDLY |



### GENERAL SPECIFICATIONS

- High frequency on-line double conversion technology
- DSP (Digital signal processors) control technology
- Active power factor correction (APFC), input power factor up to 0.99
- Output power factor 0.9
- Wide input voltage range (110 V ~ 300 Vac) and frequency range (40 ~ 70 Hz)
- Auto sensing frequency
- 50/60Hz frequency conversion
- Cold start
- Rear ventilation design and variable speed fan
- Effective software and hardware protection
- Quick and stable charging, 90% capacity restored in 4h (standard model UPS)
- Linear derating in low voltage input reducing battery discharging times
- Settable delayed start when power is restored
- Hot-swappable battery
- Advanced battery management (ABM)
- Multiple functions settable via LCD: output voltage, EOD, autostart, bypass mode, ECO mode and frequency conversion mode
- Multi-platform communications: RS232 (standard), USB / RS485 / SNMP / dry contacts (optional)
- Optional USB, RS485 card, AS400 dry contacts, SNMP card, SMS alarms, EPO function, MBS (External maintenance bypass switch)

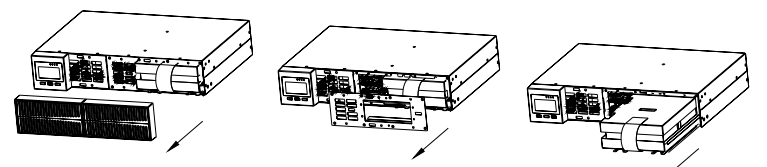
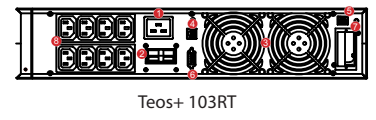
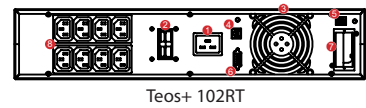
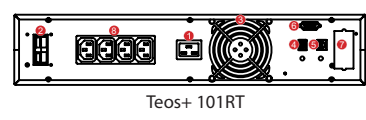

Easy for maintenance, hot-swappable battery

#### REAR PANEL

- |                                 |                     |
|---------------------------------|---------------------|
| 1- AC input socket              | 5- EPO (optional)   |
| 2- Battery connector (optional) | 6- RS232            |
| 3- Fan                          | 7- Intelligent slot |
| 4- USB (optional)               | 8- Output sockets   |

## TECHNICAL SPECIFICATIONS

| MODEL                            | Teos+ 101RT   | Teos+ 102RT          | Teos+ 103RT          |            |
|----------------------------------|---|----------------------|----------------------|------------|
| Power                            | 1 kVA / 900 W   | 2 kVA / 1800 W       | 3 kVA / 2700 W       |            |
| <b>INPUT</b>                     |   |                      |                      |            |
| Rated voltage                    | 208 / 220 / 230 / 240 Vac (settable via LCD)  |                      |                      |            |
| Voltage range                    | 110 ~ 176 Vac (linear derating between 50% and 100% load); 176 ~ 280 Vac (no derating); 280 ~ 300 Vac (derating 50%)  |                      |                      |            |
| Frequency                        | 40 ~ 70 Hz (auto-sensing)   |                      |                      |            |
| Power factor                     | ≥ 0.99  |                      |                      |            |
| Bypass voltage range             | -25% ~ +15% (settable)  |                      |                      |            |
| Total harmonic distortion (THDi) | ≤ 6%  |                      |                      |            |
| <b>OUTPUT</b>                    |   |                      |                      |            |
| Voltage                          | 208 / 220 / 230 / 240 Vac (settable via LCD)  |                      |                      |            |
| Voltage regulation               | ± 1%  |                      |                      |            |
| Frequency                        | 45 ~ 55 Hz or 55 ~ 65 Hz (synchronized range); 50 / 60 Hz ± 0.1 Hz (battery mode)   |                      |                      |            |
| Waveform                         | Sinusoidal  |                      |                      |            |
| Power factor                     | 0.9   |                      |                      |            |
| Total harmonic distortion (THDv) | ≤ 2% (linear load); ≤ 5% (non-linear load)  |                      |                      |            |
| Crest factor                     | 3:1   |                      |                      |            |
| Overload                         | 105% ~ 125% for 1 min, 125% ~ 150% for 30 s, > 150% for 300 ms  |                      |                      |            |
| <b>BATTERY</b>                   |   |                      |                      |            |
| DC voltage                       | 24V   | 48V                  | 72V                  | 96V        |
| Inbuilt battery                  | 2x12V/9Ah   | 4x12V/9Ah            | 6x12V/9Ah            | /          |
| Charging current (max.)          | 1A  |                      |                      | 6A         |
| Recharge time                    | Standard model: 90% capacity restored in 3 hours<br>Long time model: depend on the capacity of battery  |                      |                      |            |
| <b>SYSTEM</b>                    |   |                      |                      |            |
| Efficiency                       | ≥ 90% (Mains mode)  | ≥ 91% (Mains mode)   | ≥ 92% (Mains mode)   |            |
|                                  | ≥ 85% (Battery mode)  | ≥ 86% (Battery mode) | ≥ 87% (Battery mode) |            |
|                                  | ≥ 95% (ECO mode)  | ≥ 96% (ECO mode)     | ≥ 97% (ECO mode)     |            |
| Transfer time                    | Mains mode to battery mode: 0 ms<br>Inverter mode to bypass mode: 4 ms (typical)  |                      |                      |            |
| Protections                      | Short-circuit, overload, overtemperature, battery discharge protection and fan testing protection   |                      |                      |            |
| Communications                   | RS232 (standard), USB / RS485 / dry contacts / SNMP (optional)  |                      |                      |            |
| Display                          | LCD + LED   |                      |                      |            |
| Standards                        | EN 62040-1, EN 62040-2, EN 61000-3-2, EN 61000-3-3, IEC 61000-4-2, IEC 61000-4-3, IEC 61000-4-4, IEC 61000-4-5, IEC 61000-4-6, IEC 61000-4-8, IEC 61000-4-11, IEC 61000-2-2, IEC 62040-2, IEC 62040-1 |                      |                      |            |
| <b>GENERAL</b>                   |   |                      |                      |            |
| Operating temperature            | 0°C ~ 40°C  |                      |                      |            |
| Storage temperature              | - 25°C ~ 55°C (without battery)   |                      |                      |            |
| Relative humidity                | 0 ~ 95% (non-condensing)  |                      |                      |            |
| Altitude                         | ≤ 1000 m, derating 1% for each additional 100 m   |                      |                      |            |
| IP rating                        | IP 20   |                      |                      |            |
| Noise level at 1m                | ≤ 50 dB   |                      |                      |            |
| Dimensions (HxWxD) (mm)          | 88x440x338  | 88x440x430           | 88x440x560           | 88x440x468 |
| Packaged dimensions (HxWxD) (mm) | 194x545x428   | 201x545x560          | 201x545x690          | 88x440x592 |
| Net weight (kg)                  | 10.6  | 18.7                 | 26.8                 | 10.1       |
| Gross weight (kg)                | 11.3  | 21.8                 | 29.7                 | 13.6       |